



Thesally Road

Description
General information

Client: Jason Tait, Wandsworth Design Service
Architect: Richard Williams
Area: 1530 m2 / 15 dwelling between houses and flats.
Location: Thesally Road, Wandsworth council
Reference number: GT054

Consulting jobs

- Code for Sustainable Homes Assessment (CSH)
- Standard Assessment Procedure (SAP)
- Energy Strategy report / studies
- Renewable Energy Feasibility studies
- Daylighting calculations

Sustainable evaluation

The project is certifying for a **CODE 4 for the Code for Sustainable Homes scheme**.
The **energy strategy** for the proposed scheme is to use a highly efficient gas boiler alongside advanced energy efficiency measures and a 82 m2 solar Photovoltaic array to meet the carbon emissions reductions target set by Wandsworth Council.

The proposal is to insulate the building to best practice standards, surpassing Part L requirements. The thermal performance targets of the dwelling are the following: U-Values of 0.16 W/m2K for the ground floor and roof, 0.14 W/m2K for walls and windows of 1.3 W/m2K. An air permeability of 3 m3/m2/hr at 50 pa is targeted, and to be achieved on site.

Thermal bridging will also be kept to a minimum with an average Y-value of 0.08, thus following accredited construction details for all dwellings as a minimum.

A mechanical ventilation system with heat recovery (MVHR) will be implemented in the dwelling, recycling heat that would otherwise be lost. This ventilation system will meet the requirements of Part F.

The **Daylight calculations** (ADF) reports that the Kitchens area achieves a minimum average daylight factor of more than 2%, and the living rooms, dining room and studies achieve a minimum average daylight factor of more than 1.5%. Also that the surrounding buildings have not been affected by the projected shadow of the new building. Likewise the Sunlight calculations (APSH) are that ever flat for this development meets the requirements recommended by BRE, having 5% of sunlight hours on winter months and 25% of the entire year.

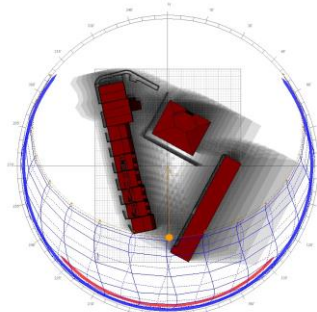
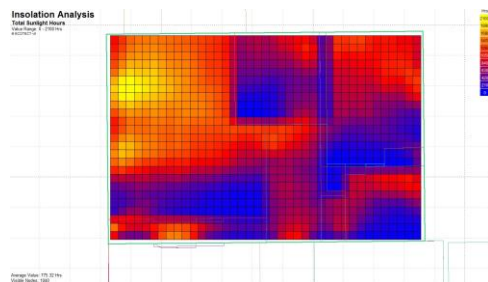

Code for Sustainable Homes									
Job No: GT054									
Wandsworth Thesally									
Score Summary August 2014									
		Points	Max	Weighted points	Max	Weighted points	Max	Weighted points	Max
Energy	Sub 1	Carbon Emission	1	10	10.00	10	10.00	10	10.00
	Sub 2	Building fabric	4	9	36.00	4	36.00	4	36.00
	Sub 3	Energy Efficient Design	2	2	4.00	2	4.00	2	4.00
	Sub 4	Drying space	3	3	9.00	3	9.00	3	9.00
	Sub 5	Ecological aspects	2	2	4.00	2	4.00	2	4.00
	Sub 6	Green spaces	2	2	4.00	2	4.00	2	4.00
	Sub 7	Zero/Low Carbon Energy Source	1	2	2.00	1	2.00	1	2.00
	Sub 8	Green Storage	2	2	4.00	2	4.00	2	4.00
Water	Sub 1	Water Efficiency	1	1	1.00	1	1.00	1	1.00
	Sub 2	External Water Use	1	1	1.00	1	1.00	1	1.00
Materials	Sub 1	Environmental Impact of Materials	2	4	8.00	2	8.00	2	8.00
	Sub 2	Responsible Sourcing: Basic elements	4	4	16.00	4	16.00	4	16.00
Surface Water	Sub 1	Responsible Sourcing: Timber elements	4	4	16.00	4	16.00	4	16.00
	Sub 2	Reduction of Surface Runoff	2	2	4.00	2	4.00	2	4.00
Waste	Sub 1	Responsible Sourcing: Tiles	2	2	4.00	2	4.00	2	4.00
	Sub 2	Site Waste Management Plan	3	3	9.00	3	9.00	3	9.00
Pollution	Sub 1	Contaminating	2	2	4.00	2	4.00	2	4.00
	Sub 2	Vehicle Emissions	1	1	1.00	1	1.00	1	1.00
Health and Wellbeing	Sub 1	Daylighting	3	1.50	4.50	3	1.50	4.50	3
	Sub 2	Sound Protection	1	1	1.00	1	1.00	1	1.00
	Sub 3	Private spaces	1	1	1.00	1	1.00	1	1.00
	Sub 4	Access to Green Spaces	2	2	2.00	2	2.00	2	2.00
Management	Sub 1	Home user guide	3	3	9.00	3	9.00	3	9.00
	Sub 2	Construction Construction Scheme	2	2	6.00	2	6.00	2	6.00
	Sub 3	Construction Site Impacts	2	2	6.00	2	6.00	2	6.00
	Sub 4	Security, ACD	2	2	6.00	2	6.00	2	6.00
Land Use and Ecology	Sub 1	Ecological Enhancement	1	1	1.00	1	1.00	1	1.00
	Sub 2	Provision of Ecological Features	1	1	1.00	1	1.00	1	1.00
	Sub 3	Change of Ecological Value of Site	2	4	8.00	2	4	8.00	2
	Sub 4	Change of Ecological Value of Site	2	4	8.00	2	4	8.00	2
	Sub 5	Building Envelope	1	1	1.00	1	1.00	1	1.00
			Score	68.00	Score	68.00	Score	68.00	Score
				Rating: Level 4		Rating:	Level 4		Level 4